



DIESEL GENERATOR SET LG33YD SPECIFICATION

MODEL		Power rating		Voltage available		
		PRIME(1)	STANDBY(2)			
LG33YD	400V/50Hz	24KW	26.4KW	380/220v	400/230v	415/240v
	PF:0.8	30KVA	33KVA			

GENERAL INFORMATION

DIESEL GENERATOR SET

Model	LG33YD
Motor	YANGDONG Y4102D
Alternator	LEEGA LA184G25
Speed Control type	Mechanical governor
Phase	Three
Fuel Tank Capacity	60 L
System Voltage	12V
Frequency	50HZ
Fuel injection pump	YTO made

ENGINE

Maximum output(kw)	29.7KW(50Hz)
Number of Cylinders	4
Aspiration	Naturally aspirated
Cycle	4
Fuel Type	Diesel
Combustion Type	Indirect Injection
Cooling Type	Water cooled
Bore	102mm
Stroke	118mm
Displacement	3.857 L
Compression Ratio	18:1
Lubrication Capacity	8 liter
Coolant Capacity	10 liter

FUEL CONSUMPTION	1500 RPM
	L/hr
Standby Power(2)	235g/kw.h
Prime Power(1)	7.7l/h (235g/kw.h)

DIMENSION	OPEN	SILENT
Length (A)	1880mm	2250mm
Width (B)	760 mm	850mm
Height (C)	1300mm	1280mm
Net Weight	795 kg	990kg

Alternator

Insulation	Clase"H"
Excitation Type	Self-excitation
Protection class	IP23

Certificates

Engine	ISO 3046, BS 5514, DIN 6271
Alternator	UTE NFC 51-111-105-110
	ICE34-1, BS 5000-4999
	NEMA MG 21, VDE 0530
Generator Set	ISO 8528

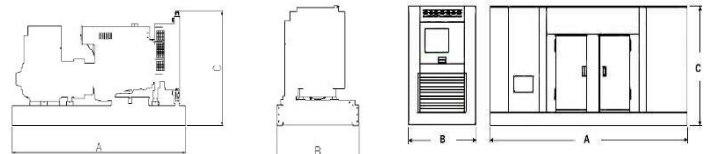

(1)Prime Power: ratings are as per DIN 6271, BS55114 and ISO-3046 with 10% overload capacity

(2)Standby Power: Power available at variable load for up to a maximum of 500 hours during one year of which 300 hours may be for continuous u

(3)Operation at Altitude \leq 1500m, Ambient temperature \leq 40°C). If altitude higher than 1500m, each 300m will cause additional de-rating 4%.

Certificacion ISO 9001:2000

Fujian Everstrong Lega Power Equipments Co., Ltd
Address: Fuqing Hong Kuan Industry Zone, Fuzhou, Fujian Province, China
Tel: +86-591-83859146
Fax: +86-591-83853130
Email: sales@legapower.com
Web: www.legapower.com

We are always available™

